

Heavy wall spacers have greater compression strength and additional bearing surface. Contact Spirol for compression specifications and bearing surface requirements based on your application.

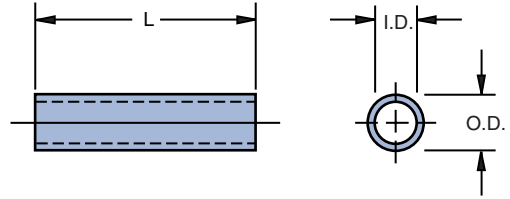

METRIC SPECIFICATIONS

Nominal Spacer Size		3 mm	3.5 mm	4 mm	5 mm	6 mm	8 mm	10 mm	12 mm	14 mm	16 mm	20 mm	24 mm	
SP100 Std. Wall	I.D.	Min.	3.15	3.65	4.15	5.2	6.2	8.2	10.2	12.25	14.25	16.25	20.4	24.4
		Max.	3.3	3.8	4.3	5.4	6.4	8.5	10.5	12.7	14.8	16.8	21	25.2
	Wall Thickness	0.5	0.5	0.7	0.7	0.9	1.1	1.2	1.6	1.8	1.8	2	2.4	
	O.D. Ref. Only	4.25	4.75	5.65	6.7	8.1	10.55	12.75	15.7	17.75	20.15	24.7	29.6	
SP150 Heavy Wall	I.D.	Min.	3.1	3.6	4.1	5.1	6.1	8.1	10.1	12.15	-	16.15	20.2	-
		Max.	3.3	3.85	4.35	5.4	6.4	8.6	10.6	13	-	17.1	21.2	-
	Wall Thickness	0.7	0.9	1	1.2	1.5	1.7	2	2.2	-	2.6	2.8	-	
	O.D. Ref. Only	4.6	5.55	6.45	7.65	9.25	11.75	14.35	17.0	-	21.85	26.3	-	

STANDARD SIZES

Nominal Spacer Size		3 mm	3.5 mm	4 mm	5 mm	6 mm	8 mm	10 mm	12 mm	14 mm	16 mm	20 mm	24 mm
Length	4												
	5												
	6												
	8												
	10												
	12												
	14												
	16												
	18												
	20												
	22												
	25												
	28												
	30												
	35												
	40												
	45												
	50												
	55												
	60												
	65												
	70												
	75												
	80												
85													
90													
95													
100													
110													
120													
130													
140													
150													

LENGTH TOLERANCE
SP100 ± 0.15 mm
SP150 ± 0.2 mm

LENGTH TOLERANCE
SP100 ± 0.25 mm
SP150 ± 0.4 mm

LENGTH TOLERANCE
SP100 ± 0.4 mm
SP150 ± 0.5 mm

LENGTH TOLERANCE
SP100 ± 0.25 mm
SP150 ± 0.3 mm

LENGTH TOLERANCE
SP100 ± 0.4 mm
SP150 ± 0.5 mm

LENGTH TOLERANCE
SP100 ± 0.5 mm
SP150 ± 0.6 mm

MATERIALS	FINISHES
F Low Carbon Steel	K Plain ²
D Austenetic Stainless Steel ¹	T Zinc Plated
A Aluminum ¹	R Phosphate Coated

INSPECTION METHODS
I.D. - Go and No Go Plug Gauges
Length - Calipers

PART NUMBER
Product Type, Size x Length, Material Finish, Series
Example SPCR 6 x 40 FK SP 100 SPCR .250 x 1.125 FK SP 100
 Standard Lengths shorter, longer and intermediate lengths are available on request.

¹ Only standard up to 1/4" and 6 mm diameters
² Plain finish Carbon Steel parts have a protective oil finish

INCH SPECIFICATIONS

Nominal Spacer Size		#4	#6	#8	#10	.250 1/4	.312 5/16	.375 3/8	.437 7/16	.500 1/2	.625 5/8	.750 3/4	.875 7/8	1.000 1	
SP100 Standard Wall	I.D.	Min.	.118	.144	.172	.198	.260	.322	.385	.449	.512	.637	.767	.892	1.017
		Max.	.124	.150	.180	.206	.268	.332	.395	.464	.532	.657	.792	.922	1.047
	Wall Thickness	.021	.021	.027	.027	.036	.042	.048	.048	.062	.072	.078	.083	.094	
	O.D. Ref. Only	.160	.190	.230	.255	.335	.410	.485	.550	.645	.790	.935	1.075	1.250	
SP150 Heavy Wall	I.D.	Min.	.116	.142	.168	.194	.254	.318	.381	-	.508	.632	.758	-	-
		Max.	.124	.152	.180	.206	.268	.338	.401	-	.538	.672	.798	-	-
	Wall Thickness	.027	.036	.042	.048	.058	.067	.078	-	.094	.102	.110	-	-	
	O.D. Ref. Only	.175	.220	.260	.295	.375	.460	.545	-	.710	.855	1.000	-	-	

STANDARD SIZES

Nominal Spacer Size		#4	#6	#8	#10	.250 1/4	.312 5/16	.375 3/8	.437 7/16	.500 1/2	.625 5/8	.750 3/4	.875 7/8	1.000 1	
Length	.187 3/16														
	.250 1/4														
	.312 5/16														
	.375 3/8														
	.437 7/16														
	.500 1/2														
	.562 9/16														
	.625 5/8														
	.687 11/16														
	.750 3/4														
	.812 13/16														
	.875 7/8														
	.937 15/16														
	1.000 1														
	1.125 1-1/8														
	1.250 1-1/4														
	1.375 1-3/8														
	1.500 1-1/2														
	1.625 1-5/8														
	1.750 1-3/4														
	1.875 1-7/8														
	2.000 2														
	2.250 2-1/4														
	2.500 2-1/2														
	2.750 2-3/4														
	3.000 3														
	3.250 3-1/4														
	3.500 3-1/2														
	3.750 3-3/4														
	4.000 4														
4.250 4-1/4															
4.500 4-1/2															
4.750 4-3/4															
5.000 5															
5.250 5-1/4															
5.500 5-1/2															
5.750 5-3/4															
6.000 6															